

PI SERIES

85°C, Screw terminal type

■ Features

- 85°C, Screw terminal
- Smaller dimensions and large capacity
- Large allowable ripple current
- Load life of 5,000 hours at 85°C



■ Specifications

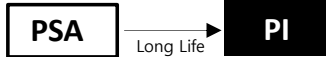

Item	Performance Characteristics	
Operating temperature range	-25°C ~ +85°C	
Rated working voltage range	315V ~ 500V	
Nominal capacitance range	1,500 µF ~ 15,000 µF , ±20% (at 20°C, 120Hz)	
D.C Leakage current(at 20°C)	The following specifications shall be satisfied when the rated voltage is applied for the required time	
	$I \leq 0.02CV$ or 5mA (5min), whichever is less.	
	Where I = Leakage current(µA) C = Nominal capacitance(µF) V = Rated voltage (V)	
Tan δ (max., at 20°C, 120Hz)	W.V	315~500
	Tan δ	0.20
Characteristics at low temperature(max.) (impedance ratio at 120Hz)	W.V(V)	315~500
	Z-25°C/Z+20°C	8
Load life	After applying rated working voltage for 5,000 hours at +85°C and then listed being stabilized at +20°C, capacitors shall meet following limits.	
	Capacitance change	Within ± 30% of the initial measured value
	Tan δ	≤ 300% of the initial specified value
	Leakage current	≤ The initial specified value
Shelf life	After storage for 1,000hours at + 85°C with no voltage applied and then being stabilized at +20°C, capacitors shall meet following limits.	
	Capacitance change	Within ± 20% of the initial measured value
	Tan δ	≤ 300% of the initial specified value
	Leakage current	≤ The initial specified value

■ Dimensions

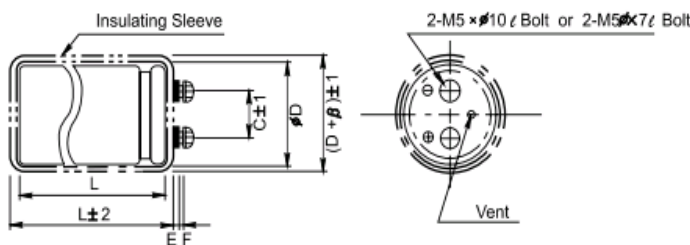

Φ D	C	E	F	β
35	12.7	2.5	6.0	1.0
51	22.0	2.5	6.0	1.5
63.5	28.6	2.5	6.0	1.5
76	31.0	1.5	6.5	1.5
89	0.5	1.5	6.5	1.5

■ Ripple current coefficient

• Frequency

W.V(V) \ Freq(Hz)	50	120	1K	10K	100K
315~500	0.8	1.0	1.2	1.3	1.4

PI SERIES

■ Dimensions & Maximum permissible ripple current

μF \ V	315	350	400	450	500
1,500					63.5 x 90 5.8
1,800					63.5 x 100 6.7
2,200					63.5 x 120 7.8
2,700	63.5 x 90 8.3			63.5 x 120 9.1	76 x 110 9.0
3,300	63.5 x 100 10.2		63.5 x 120 10.1	63.5 x 130 10.7	76 x 130 10.5
3,900	63.5 x 110 11.1	63.5 x 120 11.1	63.5 x 130 11.7	76 x 120 12.5	76 x 140 11.5
4,700	63.5 x 120 12.8	63.5 x 130 13.0	76 x 120 13.7	76 x 130 14.6	76 x 150 12.8
5,600	63.5 x 150 14.2	76 x 120 15.1	76 x 130 16.0	76 x 160 17.2	89 x 150 14.5
6,800	76 x 120 17.3	76 x 130 17.6	76 x 160 19.2	76 x 170 19.6	89 x 170 17.0
8,200	76 x 150 19.7	76 x 160 20.2	76 x 170 20.9	89 x 160 22.0	89 x 190 20.0
10,000	76 x 160 22.8	76 x 170 23.2	89 x 160 25.0	89 x 170 24.8	
12,000	89 x 150 26.5	89 x 160 27.1	89 x 170 27.0		
15,000	89 x 180 30.0	89 x 190 32.3			
Case size : $\Phi\text{D} \times \text{L}(\text{mm})$ Maximum permissible ripple current [A(rms) at 85°C, 120Hz]					