

PSL SERIES

85°C, Screw terminal type

Features

- 85°C, Screw terminal
- Large allowable ripple current
- High reliability continuous operation
- Load life of 20,000 hours at 85°C



Specifications

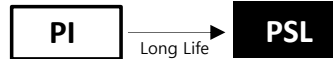

Item	Performance Characteristics	
Operating temperature range	-25°C ~ +85°C	
Rated working voltage range	400V	
Nominal capacitance range	4,700 µF ~ 8,200 µF , ±20% (at 20°C, 120Hz)	
D.C Leakage current(at 20°C)	The following specifications shall be satisfied when the rated voltage is applied for the required time $I \leq 0.02CV$ or 5mA (5min), whichever is smaller. Where I = Leakage current(µA) C = Nominal capacitance(µF) V = Rated voltage (V)	
Tan δ (max., at 20°C, 120Hz)	W.V	400
	Tan δ	0.15
Characteristics at low temperature(max.) (impedance ratio at 120Hz)	W.V(V)	400
	Z-25°C/Z+20°C	8
Load life	After applying rated working voltage for 20,000 hours at +85°C and then listed being stabilized at +20°C, capacitors shall meet following limits.	
	Capacitance change	Within ± 30% of the initial measured value
	Tan δ	≤ 300% of the initial specified value
	Leakage current	≤ The initial specified value
Shelf life	After storage for 1,000hours at + 85°C with no voltage applied and then being stabilized at +20°C, capacitors shall meet following limits.	
	Capacitance change	Within ± 20% of the initial measured value
	Tan δ	≤ 300% of the initial specified value
	Leakage current	≤ The initial specified value

Dimensions

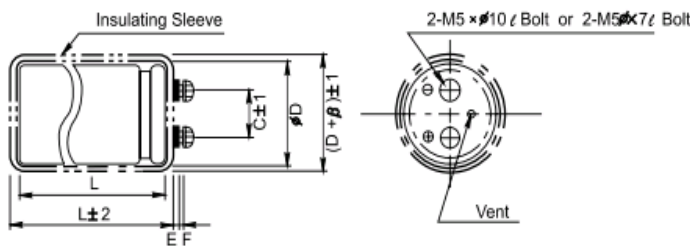

Φ D	C	E	F	β
35	12.7	2.5	6.0	1.0
51	22.0	2.5	6.0	1.5
63.5	28.6	2.5	6.0	1.5
76	31.0	1.5	6.5	1.5
89	0.5	1.5	6.5	1.5

Ripple current coefficient

• Frequency

W.V(V) \ Freq(Hz)	50	120	1K	10K	100K
400	0.8	1.0	1.2	1.3	1.4

Dimensions & Ripple current

µF \ V	400
4,700	76 x 110
	5.8
5,600	76 x 130
	6.7
6,800	76 x 150
	7.8
8,200	76 x 150
	9.0

Case size : ΦD x L(mm)
Maximum permissible ripple current [A(rms) at 85°C, 120Hz]