

PUL SERIES

105°C, Screw terminal type

■ Features

- 105°C, Screw terminal
- Large allowable ripple current
- High reliability for continuous operation
- Load life of 5,000 hours at 105°C



■ Specifications



Item	Performance Characteristics	
Operating temperature range	-25°C ~ +105°C	
Rated working voltage range	250V ~ 450V	
Nominal capacitance range	220 μF ~ 10,000 μF , ±20% (at 20°C, 120Hz)	
D.C Leakage current(at 20°C)	The following specifications shall be satisfied when the rated voltage is applied for the required time $I \leq 0.02CV\mu A$ or 5mA (5min), whichever is smaller. Where I = Leakage current(μA) C = Nominal capacitance(μF) V = Rated voltage (V)	
Tan δ (max., at 20°C, 120Hz)	$\frac{V}{\mu F}$	250~450
	220~12,000	0.15
Characteristics at low temperature(max.) (impedance ratio at 120Hz)	W.V(V)	250~450
	Z-25°C/Z+20°C	6
	Z-40°C/Z+20°C	-
Load life	After applying rated working voltage for 5,000 hours at +105°C and then listed being stabilized at +20°C, capacitors shall meet following limits.	
	Capacitance change	Within ± 20% of the initial measured value
	Tan δ	≤ 200% of the initial specified value
	Leakage current	≤ The initial specified value
Shelf life	After storage for 1,000hours at + 105°C with no voltage applied and then being stabilized at +20°C, capacitors shall meet following limits.	
	Capacitance change	Within ± 20% of the initial measured value
	Tan δ	≤ 200% of the initial specified value
	Leakage current	≤ The initial specified value

■ Dimensions

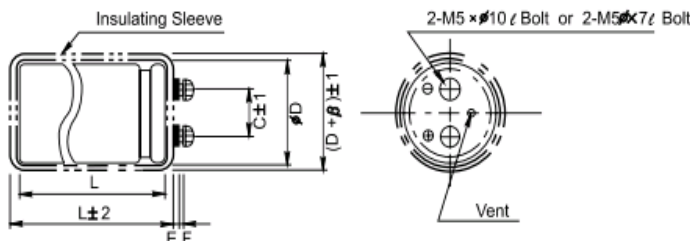

Φ D	C	E	F	β
35	12.7	2.5	6.0	1.0
51	22.0	2.5	6.0	1.5
63.5	28.6	2.5	6.0	1.5
76	31.0	1.5	6.5	1.5
89	0.5	1.5	6.5	1.5

■ Ripple current coefficient

• Frequency

W.V(V)	Freq(Hz)	50	120	1K	10K	100K
250~450		0.8	1.0	1.2	1.3	1.4

PUL SERIES

▣ Dimensions & Maximum permissible ripple current

μF \ V	250	350	400	450
220		35 x 80 1.5	35 x 80 1.7	35 x 80 1.7
330		35 x 80 2.1	35 x 80 2.2	35 x 100 2.3
470		35 x 80 2.8	35 x 100 3.0	51 x 80 3.3
680	35 x 80 1.5	51 x 80 4.0	51 x 80 4.0	51 x 100 4.2
1,000	35 x 100 2.0	51 x 80 6.0	51 x 80 6.5	51 x 100 6.8
1,500	51 x 80 2.5	51 x 100 8.5	51 x 120 8.8	51 x 120 8.8
2,200	51 x 100 3.2	51 x 120 10.0	63.5 x 100 11.0	63.5 x 120 11.6
2,700	51 x 120 3.7	63.5 x 100 12.0	63.5 x 110 12.6	63.5 x 130 13.4
				76 x 120 14.3
3,300	63.5 x 100 4.3	63.5 x 120 13.7	63.5 x 130 14.8	63.5 x 160 16.1
				76 x 130 16.7
3,900	63.5 x 100 5.2	63.5 x 130 16.0	76 x 120 17.0	63.5 x 170 18.0
4,700	63.5 x 120 5.5	63.5 x 160 19.2	63.5 x 170 20.0	76 x 160 21.0
		76 x 120 19.1	76 x 130 19.7	
5,600	63.5 x 150 6.3	63.5 x 170 22.2	76 x 160 22.8	76 x 190 25.8
		76 x 130 22.0		89 x 160 23.5
6,800	76 x 150 6.8	76.5 x 160 25.4	76 x 170 26.5	89 x 170 27.0
			89 x 160 26.0	
8,200	76 x 150 8.0	76.5 x 170 29.1	89 x 170 29.3	89 x 190 31.1
		89 x 150 29.3		
10,000	76 x 160 9.0	89 x 170 31.7		
Case size : $\Phi\text{D} \times \text{L}(\text{mm})$ Maximum permissible ripple current [A(rms) at 105°C, 120Hz]				