

PWC SERIES

85°C, Screw terminal type

■ Features

- 85°C, Screw terminal, For welder
- Smaller dimensions and large capacity
- Large allowable ripple current
- Load life of 2,000 hours at 85°C



■ Specifications

Item	Performance Characteristics	
Operating temperature range	-25°C ~ +85°C	
Rated working voltage range	315V ~ 400V	
Nominal capacitance range	560 μF ~ 6,800 μF , ±20% (at 20°C, 120Hz)	
D.C Leakage current(at 20°C)	The following specifications shall be satisfied when the rated voltage is applied for the required time	
	$I \leq 0.02CV\mu A$ or 5mA (5min), whichever is greater.	
	Where I = Leakage current(μA) C = Nominal capacitance(μF) V = Rated voltage (V)	
Tan δ (max., at 20°C, 120Hz)	W.V	315~400
	Tan δ	0.10
Characteristics at low temperature(max.) (impedance ratio at 120Hz)	W.V(V)	315~400
	Z-25°C/Z+20°C	6
Load life	After applying rated working voltage for 2,000 hours at +85°C and then listed being stabilized at +20°C, capacitors shall meet following limits.	
	Capacitance change	Within ± 20% of the initial measured value
	Tan δ	≤ 200% of the initial specified value
	Leakage current	≤ The initial specified value
Shelf life	After storage for 1,000hours at + 85°C with no voltage applied and then being stabilized at +20°C, capacitors shall meet following limits.	
	Capacitance change	Within ± 20% of the initial measured value
	Tan δ	≤ 200% of the initial specified value
	Leakage current	≤ The initial specified value

■ Dimensions

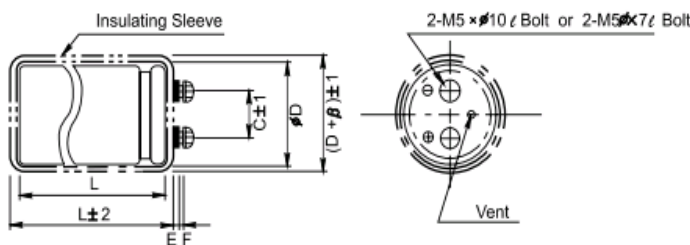

Φ D	C	E	F	β
35	12.7	2.5	6.0	1.0
51	22.0	2.5	6.0	1.5
63.5	28.6	2.5	6.0	1.5
76	31.0	1.5	6.5	1.5
89	0.5	1.5	6.5	1.5

■ Ripple current coefficient

• Frequency

W.V(V)	Freq(Hz)	50	120	1K	10K	100K
315~400		0.8	1.0	1.2	1.3	1.4

PWC SERIES

▣ Dimensions & Maximum permissible ripple current

μF \ V	315	350	400
560	35 x 100 2.5	35 x 70 2.8	35 x 70 2.8
680	35 x 110 3.0	35 x 80 4.0	35 x 80 4.0
820	35 x 120 3.4	35 x 90 4.5	35 x 90 4.5
1,000	35 x 150 3.8	35 x 100 5.0	51 x 70 5.0
1,200	35 x 120 5.4	35 x 120 6.2	51 x 80 6.2
1,500	35 x 150 6.5	51 x 80 7.4	51 x 90 7.4
1,800	35 x 160 7.0	51 x 90 8.5	51 x 90 10.1
2,200	51 x 150 8.1	51 x 110 9.0	51 x 100 11.7
2,700	51 x 180 9.2	51 x 120 10.2	63.5 x 110 13.7
3,300	51 x 150 9.7	63.5 x 100 10.8	63.5 x 130 16.0
3,900	63.5 x 120 11.9	63.5 x 120 12.5	63.5 x 140 19.2
4,700	63.5 x 150 13.4	76 x 100 14.1	76 x 130 20.9
5,600	63.5 x 160 14.5	76 x 120 16.3	76 x 140 25.0
6,800	76 x 150 16.6	76 x 130 18.9	76 x 170 27.0
Case size : $\Phi\text{D} \times \text{L}(\text{mm})$ Maximum permissible ripple current[A(rms) at 85°C, 120Hz]			