

PWL SERIES

85°C, Screw terminal type

■ Features

- 85°C, Screw terminal, For welder
- Smaller dimensions and large capacity
- Large allowable ripple current
- High reliability for continuous operation
- Load life of 5,000 hours at 85°C



■ Specifications



| Item | Performance Characteristics | |
|---|--|--|
| Operating temperature range | -25°C ~ +85°C | |
| Rated working voltage range | 315V ~ 400V | |
| Nominal capacitance range | 680 µF ~ 12,000 µF , ±20% (at 20°C, 120Hz) | |
| D.C Leakage current(at 20°C) | The following specifications shall be satisfied when the rated voltage is applied for the required time | |
| | I ≤ 0.02CV or 5mA (5min), whichever is less. | |
| | Where I = Leakage current(µA) C = Nominal capacitance(µF) V = Rated voltage (V) | |
| Tan δ (max., at 20°C, 120Hz) | W.V | 315~400 |
| | Tan δ | 0.10 |
| Characteristics at low temperature(max.) (impedance ratio at 120Hz) | W.V(V) | 315~400 |
| | Z-25°C/Z+20°C | 6 |
| Load life | After applying rated working voltage for 5,000 hours at +85°C and then listed being stabilized at +20°C, capacitors shall meet following limits. | |
| | Capacitance change | Within ± 30% of the initial measured value |
| | Tan δ | ≤ 300% of the initial specified value |
| | Leakage current | ≤ The initial specified value |
| Shelf life | After storage for 1,000hours at + 85°C with no voltage applied and then being stabilized at +20°C, capacitors shall meet following limits. | |
| | Capacitance change | Within ± 20% of the initial measured value |
| | Tan δ | ≤ 300% of the initial specified value |
| | Leakage current | ≤ The initial specified value |

■ Dimensions

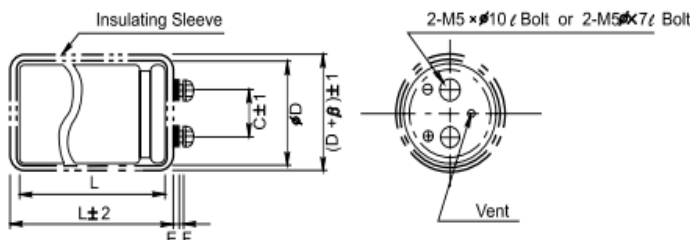

| Φ D | C | E | F | β |
|------|------|-----|-----|-----|
| 35 | 12.7 | 2.5 | 6.0 | 1.0 |
| 51 | 22.0 | 2.5 | 6.0 | 1.5 |
| 63.5 | 28.6 | 2.5 | 6.0 | 1.5 |
| 76 | 31.0 | 1.5 | 6.5 | 1.5 |
| 89 | 0.5 | 1.5 | 6.5 | 1.5 |

■ Ripple current coefficient

• Frequency

| w.V(V) \ Freq(Hz) | 50 | 120 | 1K | 10K | 100K |
|-------------------|-----|-----|-----|-----|------|
| 315~400 | 0.8 | 1.0 | 1.2 | 1.3 | 1.4 |

PWL SERIES

▣ Dimensions & Maximum permissible ripple current

| μF \ V | 315 | 350 | 400 |
|---|--------------------|--------------------|--------------------|
| 680 | | 35 x 80 4.8 | 35 x 80 3.6 |
| 820 | 35 x 80 3.4 | 35 x 100 5.1 | 35 x 110 4.2 |
| 1,000 | 35 x 110 4.3 | 35 x 110 6.1 | 51 x 70 5.0 |
| 1,200 | 35 x 120 6.4 | 35 x 120 6.7 | 51 x 80 5.8 |
| 1,500 | 51 x 80 7.6 | 51 x 90 8.5 | 51 x 100 6.7 |
| 1,800 | 51 x 90 7.1 | 51 x 100 8.9 | 51 x 110 8.1 |
| 2,200 | 51 x 90 9.1 | 51 x 110 10.4 | 51 x 100 9.2 |
| 2,700 | 51 x 120 10.8 | 63.5 x 120 11.5 | 51 x 130 10.4 |
| 3,300 | 51 x 130 12.1 | 51 x 160 13.5 | 63.5 x 140 12.4 |
| | | 63.5 x 130 13.2 | 76 x 110 11.8 |
| 3,900 | 63.5 x 120 14.5 | 63.5 x 130 15.5 | 63.5 x 150 13.4 |
| | 76 x 90 14.1 | 76 x 90 15.3 | 76 x 120 13.8 |
| 4,700 | 63.5 x 130 15.0 | 63.5 x 160 17.5 | 63.5 x 170 16.2 |
| | 76 x 100 15.4 | 76 x 120 17.3 | 76 x 140 16.4 |
| 5,600 | 63.5 x 160 16.4 | 63.5 x 190 19.5 | 76 x 160 18.5 |
| | 76 x 120 16.3 | 76 x 130 20.4 | 89 x 140 18.2 |
| 6,800 | 63.5 x 190 21.4 | 76 x 160 23.5 | 76 x 180 21.1 |
| | 76 x 130 21.1 | | |
| 8,200 | 76 x 190 22.2 | 76 x 170 24.8 | 89 x 160 24.8 |
| 10,000 | 76 x 170 25.2 | 89 x 160 27.6 | 89 x 170 28.4 |
| 12,000 | 89 x 160 29.4 | 89 x 170 34.5 | |
| Case size : $\Phi\text{D} \times \text{L}(\text{mm})$ Maximum permissible ripple current [A(rms) at 85°C, 120Hz] | | | |